

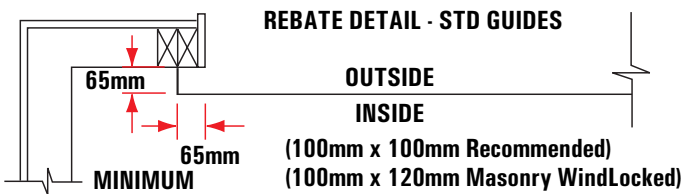

# Series A Domestic Roller Doors

**Note:** With ongoing product developments, the manufacturer retains the right to change products and specifications without prior notification. If a specification is critical to the end use, please discuss with your Dominator Dealer first.

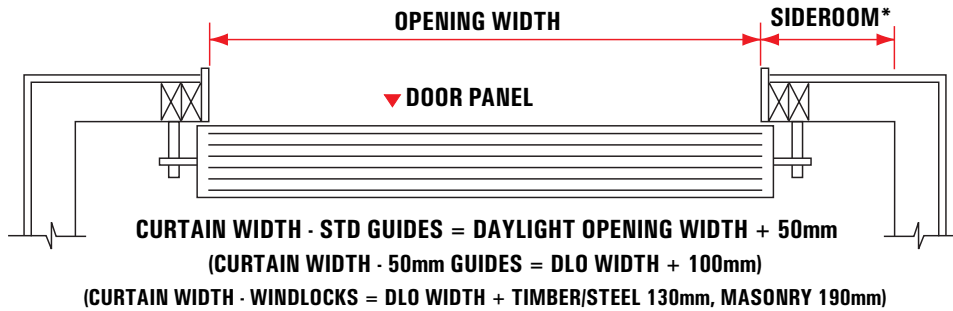

**\* SIDEROOM - STD GUIDES**  
**MANUAL OPERATION = 80mm MIN.**  
**AUTOMATIC OPERATION = 135mm MIN.**

**\* SIDEROOM - 50mm GUIDES**  
**MANUAL OPERATION = 125mm MIN.**  
**AUTOMATIC OPERATION = 185mm MIN.**

**\* SIDEROOM - WINDLOCKS**  
**TIMBER/STEEL = 135mm MIN.**  
**MASONRY = 165mm MIN.**  
*(Automation not recommended with Windlocks.)*

**NOTE:** For Automatic operation a power point on wall within 1.0m of the unit is required

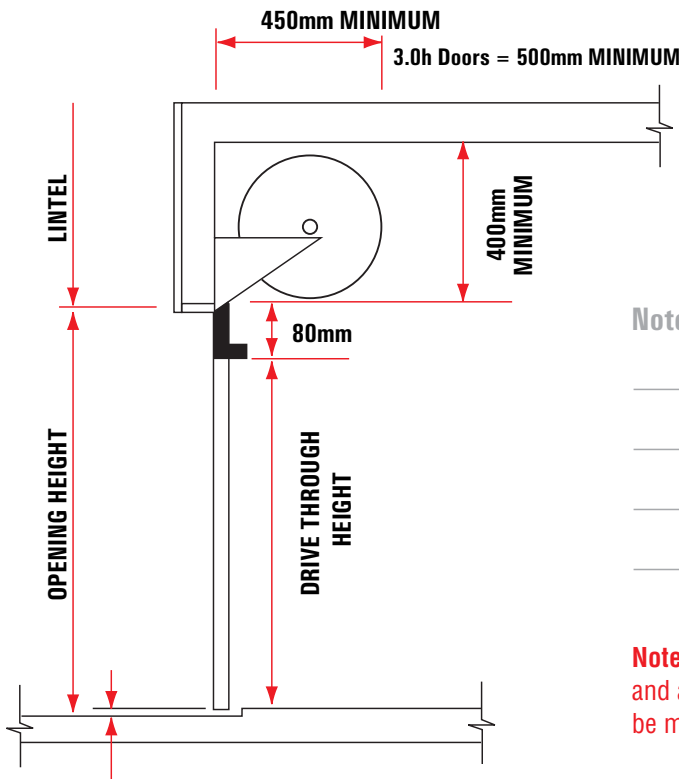

**REBATE DEPTH = 25mm (APPROX)**

**Notes:** \_\_\_\_\_  
 \_\_\_\_\_  
 \_\_\_\_\_  
 \_\_\_\_\_

**Note:** Illustrations are not accurate representations of product, and are for illustrative purposes only. All measurements should be made by your Dominator Dealer for clarification.



Contact: